

# Cylinderstopp, Cylinder stop, Zylinderhalt

## 31351, 31820, 65833

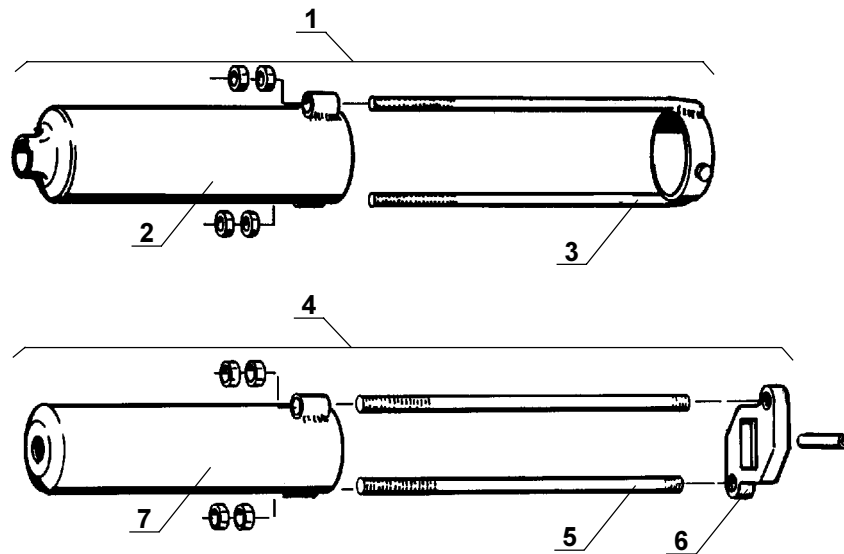

		CYLINDERSTOPP	CYLINDER STOP	ZYLINDERHALT	
Pos	Art no.	Benämning	Description	Benennung	Pos
1 ...	31351 ...	Cylinderstopp Ø 90 .....	Cylinder stop Ø 90 .....	Zylinderhalt Ø 90 .....	1 ...
2 ...	67833 ...	Skyddsrör Ø 90 .....	Protective case Ø 90 .....	Schutzrohr Ø 90 .....	2 ...
3 ...	67832 ...	Nedre fäste kpl. Ø 90 .....	Lower bracket cpl. Ø 90 .....	Unter befestigung kpl. Ø 90 .....	3 ...
4 ...	65833 ...	Cylinderstopp Ø 80, L = 360mm .....	Cylinder stop Ø 80, L = 360mm .....	Zylinderhalt Ø 80, L = 360mm .....	4 ...
4 ...	31820 ...	Cylinderstopp Ø 80, L = 570mm .....	Cylinder stop Ø 80, L = 570mm .....	Zylinderhalt Ø 80, L = 570mm .....	4 ...
5 ...	65832 ...	Dragstång, L = 360mm .....	Pull rod, L = 360mm .....	Zugstange, L = 360mm .....	5 ...
5 ...	63789 ...	Dragstång, L = 570mm .....	Pull rod, L = 570mm .....	Zugstange, L = 570mm .....	5 ...
6 ...	63784 ...	Stopp .....	Stop .....	Halt .....	6 ...
7 ...	63785 ...	Skyddsrör Ø 80 .....	Protective case Ø 80 .....	Schutzrohr Ø 80 .....	7 ...