

## ZV-50 (MA)

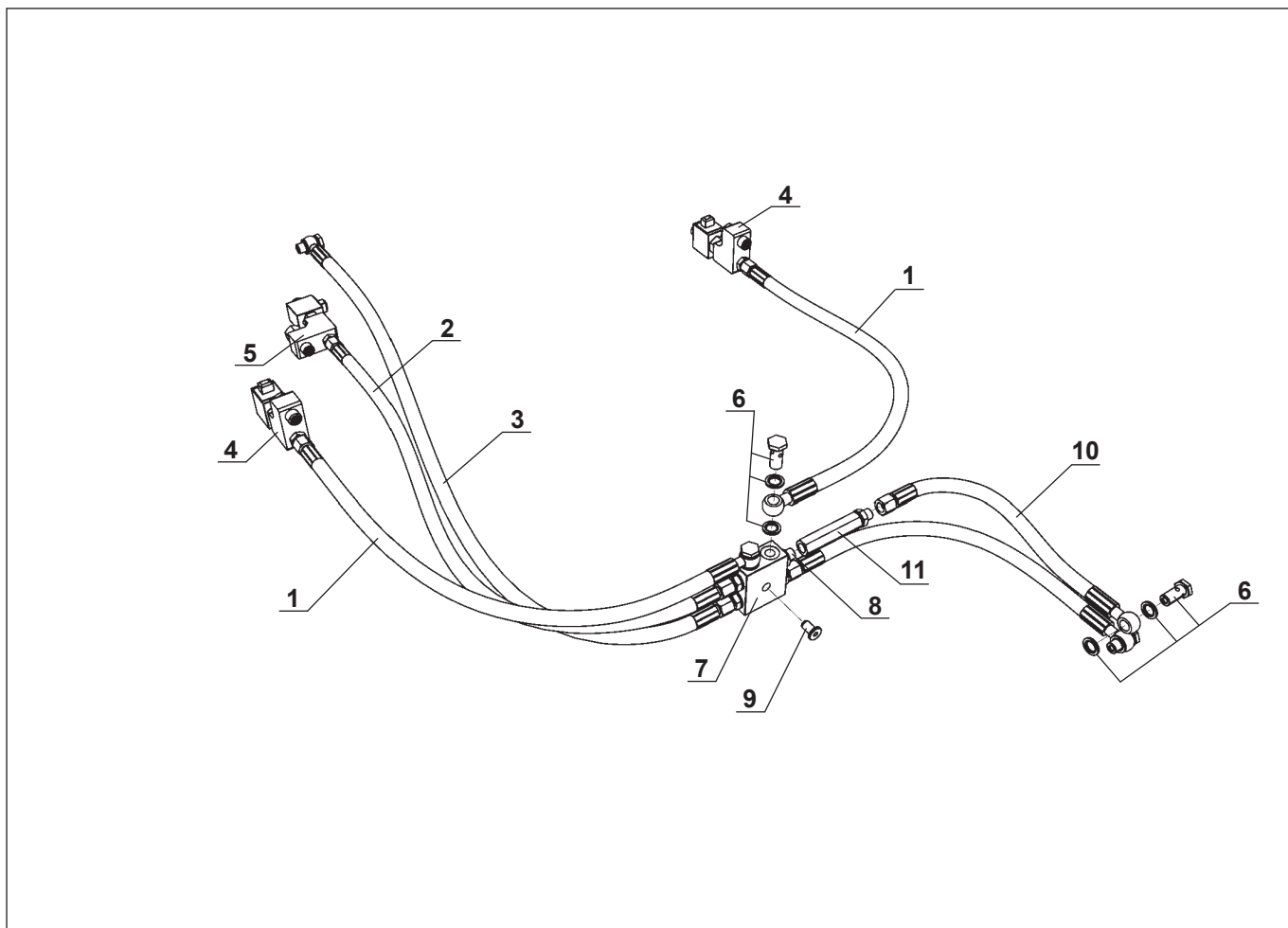

	ZV-50	HYDRAULSLANGAR	HYDRAULIC HOSES	HYDRAULIK SCHLAUCH	
Pos	Art no.	Benämning (sida nr.)	Description (page no.)	Benennung (seite nr.)	Qty.
1....	22310....	Hydraulslang 1/4" L=600mm .....	Hydraulic hose 1/4" L=600mm .....	Hydraulik Schlauch 1/4" L=600mm .....	2....
2....	21983....	Hydraulslang 1/4" L=1250mm .....	Hydraulic hose 1/4" L=1250mm .....	Hydraulik Schlauch 1/4" L=1250mm .....	1....
3....	21645....	Hydraulslang 1/4" L=1350mm .....	Hydraulic hose 1/4" L=1350mm .....	Hydraulik Schlauch 1/4" L=1350mm .....	1....
4....	54651....	El. Slangbrottsventil 12 V kpl. (9.58) .....	El. safety valve 12 V cpl (9.58).....	El. schlauchbruchsicherung 12 V kpl (9.58)	2....
4....	54882....	El. Slangbrottsventil 24 V kpl. (9.58) .....	El. safety valve 24 V cpl (9.58).....	El. schlauchbruchsicherung 24 V kpl (9.58)	2....
5....	54886....	El. Slangbrottsventil 12 V kpl. Vipp (9.59) .	El. safety valve 12 V cpl, Tilt (9.59) .....	El. schlauchbruchsicherung 12 V kpl (9.59)	1....
5....	54883....	El. Slangbrottsventil 24 V kpl. Vipp (9.59) .	El. safety valve 24 V cpl, Tilt (9.59) .....	El. schlauchbruchsicherung 24 V kpl (9.59)	1....
6....	31174....	Hälskrav kpl .....	Swivel joint cpl. ....	Lochschraube kpl. ....	3....
7....	53394....	Anslutningsblock.....	Connection block.....	Anschlussblock.....	1....
8....	20356....	Adapter .....	Adapter .....	Adapter .....	4....
9....	22309....	Möbelknapp .....	Fastener .....	Befestiger .....	1....
10...	21369....	Hydraulslang 1/4" L=2500mm .....	Hydraulic hose 1/4" L=2500mm .....	Hydraulik Schlauch 1/4" L=2500mm .....	2....
11...	22341....	Konstantflödesventil .....	Constant flow valve .....	Rückflussbremsventil.....	1....